

## PGWVZV

**Chipboard screw with double countersunk head, pozidriv**

with full thread, hardened and waxed

**Spaanderplaatschroef dubbel verzonken kop, pozidriv**

met volledige draad, gehard en gewaxt

**Vis à panneaux double tête fraisée, empreinte pozi**

avec filet complet, trempée et lubrifiée

**Spanplattenschraube Doppelflachkopf, Pozidriv Antrieb**

mit Vollgewinde, gehärtet und gleitbeschichtet



DoP: MWVZV101

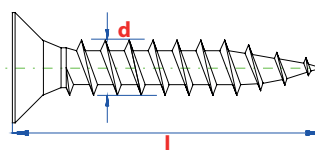
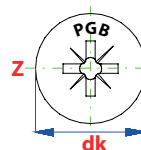

d [mm]	l [mm]	Art. Nr.	EAN code	PZ	dk [mm]		
<b>STANDARD PACKING - STANDAARDVERPAKKING - EMBALLAGE STANDARD - NORMALPACKUNG</b>							
3,0	12	PGWVZVA00003000123	5410439306782	PZ 1	6	200	28800
	16	PGWVZVA00003000163	5410439003018	PZ 1	6	200	28800
	20	PGWVZVA00003000203	5410439003025	PZ 1	6	200	28800
	25	PGWVZVA00003000253	5410439003032	PZ 1	6	200	16000
	30	PGWVZVA00003000303	5410439003049	PZ 1	6	200	16000
	35	PGWVZVA00003000353	5410439003056	PZ 1	6	200	12000
	40	PGWVZVA00003000403	5410439003063	PZ 1	6	200	9600
3,5	12	PGWVZVA00003500123	5410439101714	PZ 2	7	200	28800
	16	PGWVZVA00003500163	5410439003070	PZ 2	7	200	16000
	20	PGWVZVA00003500203	5410439003087	PZ 2	7	200	16000
	25	PGWVZVA00003500253	5410439003094	PZ 2	7	200	16000
	30	PGWVZVA00003500303	5410439003100	PZ 2	7	200	12000
	35	PGWVZVA00003500353	5410439003117	PZ 2	7	200	12000
	40	PGWVZVA00003500403	5410439003124	PZ 2	7	200	7200
4,0	12	PGWVZVA00004000123	5410439107334	PZ 2	8	200	28800
	16	PGWVZVA00004000163	5410439003131	PZ 2	8	200	16000
	20	PGWVZVA00004000203	5410439003148	PZ 2	8	200	16000
	25	PGWVZVA00004000253	5410439003155	PZ 2	8	200	12000
	30	PGWVZVA00004000303	5410439003162	PZ 2	8	200	12000
	35	PGWVZVA00004000353	5410439003179	PZ 2	8	200	9600
	40	PGWVZVA00004000403	5410439003186	PZ 2	8	200	7200
	45	PGWVZVA00004000453	5410439003193	PZ 2	8	200	7200
	50	PGWVZVA00004000503	5410439003209	PZ 2	8	200	7200
	60	PGWVZVA00004000603	5410439104760	PZ 2	8	200	4800
70	PGWVZVA00004000703	5410439108133	PZ 2	8	200	3200	

## PGWVZV

**Chipboard screw with double countersunk head, pozidriv**

with full thread, hardened and waxed

**Spaanderplaatschroef dubbel verzonken kop, pozidriv**

met volledige draad, gehard en gewaxt

**Vis à panneaux double tête fraisée, empreinte pozi**

avec filet complet, trempée et lubrifiée

**Spanplattenschraube Doppelflachkopf, Pozidriv Antrieb**

mit Vollgewinde, gehärtet und gleitbeschichtet



DoP: MWVZV101

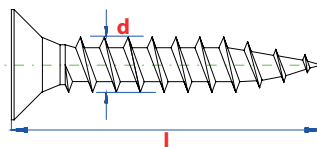
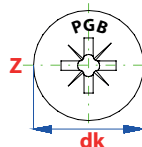

d [mm]	l [mm]	Art. Nr.	EAN code	PZ	dk [mm]		
4,5	16	PGWVZVA00004500163	5410439170000	PZ 2	9	200	16000
	20	PGWVZVA00004500203	5410439003216	PZ 2	9	200	12000
	25	PGWVZVA00004500253	5410439003223	PZ 2	9	200	12000
	30	PGWVZVA00004500303	5410439003230	PZ 2	9	200	9600
	35	PGWVZVA00004500353	5410439003247	PZ 2	9	200	7200
	40	PGWVZVA00004500403	5410439003254	PZ 2	9	200	7200
	45	PGWVZVA00004500453	5410439003261	PZ 2	9	200	7200
	50	PGWVZVA00004500503	5410439003278	PZ 2	9	200	4800
	60	PGWVZVA00004500603	5410439003285	PZ 2	9	200	3200
	70	PGWVZVA00004500703	5410439144131	PZ 2	9	200	3200
5,0	20	PGWVZVA00005000203	5410439003292	PZ 2	10	200	9600
	25	PGWVZVA00005000253	5410439003308	PZ 2	10	200	9600
	30	PGWVZVA00005000303	5410439003315	PZ 2	10	200	7200
	35	PGWVZVA00005000353	5410439003322	PZ 2	10	200	7200
	40	PGWVZVA00005000403	5410439003339	PZ 2	10	200	7200
	45	PGWVZVA00005000453	5410439003346	PZ 2	10	200	4800
	50	PGWVZVA00005000503	5410439003353	PZ 2	10	200	4800
	60	PGWVZVA00005000603	5410439003360	PZ 2	10	200	3200
	70	PGWVZVA00005000703	5410439003377	PZ 2	10	200	2400
	80	PGWVZVA00005000803	5410439003384	PZ 2	10	200	2400
	90	PGWVZVA00005000903	5410439003391	PZ 2	10	200	2400
	100	PGWVZVA00005001003	5410439003407	PZ 2	10	200	1600
110	PGWVZVA00005001203	5410439229548	PZ 2	10	200	1600	

**PGWVZV****Chipboard screw with double countersunk head, pozidriv**

with full thread, hardened and waxed

**Spaanderplaatschroef dubbel verzonken kop, pozidriv**

met volledige draad, gehard en gewaxt

**Vis à panneaux double tête fraisée, empreinte pozi**

avec filet complet, trempée et lubrifiée

**Spanplattenschraube Doppelflachkopf, Pozidriv Antrieb**

mit Vollgewinde, gehärtet und gleitbeschichtet



DoP: MWVZV101

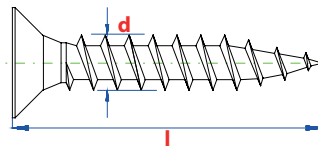
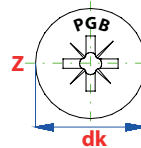

d [mm]	l [mm]	Art. Nr.	EAN code	PZ	dk [mm]		
6,0	25	PGWVZVA00006000253	5410439104715	PZ 3	12	200	7200
	30	PGWVZVA00006000303	5410439101721	PZ 3	12	200	7200
	35	PGWVZVA00006000353	5410439101738	PZ 3	12	200	4800
	40	PGWVZVA00006000403	5410439003414	PZ 3	12	200	4800
	45	PGWVZVA00006000453	5410439003421	PZ 3	12	200	3200
	50	PGWVZVA00006000503	5410439003438	PZ 3	12	200	3200
	60	PGWVZVA00006000603	5410439003445	PZ 3	12	200	2400
	70	PGWVZVA00006000703	5410439003452	PZ 3	12	200	2400
	80	PGWVZVA00006000803	5410439003469	PZ 3	12	200	1600
	90	PGWVZVA00006000903	5410439003476	PZ 3	12	200	1600
	100	PGWVZVA00006001003	5410439003483	PZ 3	12	200	1600

## PGWVZV

**Chipboard screw with double countersunk head, pozidriv**  
with full thread, hardened and waxed, collated

**Spaanderplaatschroef dubbel verzonken kop, pozidriv**  
met volledige draad, gehard en gewaxt, op band

**Vis à panneaux double tête fraisée, empreinte pozi**  
avec filet complet, trempée et lubrifiée, sur bande

**Spanplattenschraube Doppelflachkopf, Pozidriv Antrieb**  
mit Vollgewinde, gehärtet und gleitbeschichtet, auf Band

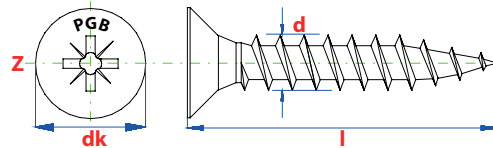

DoP: MWVZV101



d [mm]	l [mm]	Art. Nr.	EAN code	PZ	dk [mm]		
<b>INDUSTRIAL PACKING - GROOTVERPAKKING - EMBALLAGE GRAND - INDUSTRIEPAKUNG</b>							
4,0	25	PGWVZVA00004000257	5410439238816	PZ 2	8	1000	6000
	30	PGWVZVA00004000307	5410439238823	PZ 2	8	1000	6000
	35	PGWVZVA00004000357	5410439238830	PZ 2	8	1000	6000
	40	PGWVZVA00004000407	5410439238847	PZ 2	8	1000	6000
	50	PGWVZVA00004000507	5410439238854	PZ 2	8	1000	6000